

Description

All TOGGLER Specialty Anchors can be used in any material (concrete, plywood, paneling, drywall, etc.) of any thickness above their minimum grip range.

All TOGGLER Specialty Anchors install in the wall like our TOGGLER Plastic Toggle Anchors and wedge securely even if you hit a cavity in the wall with your drill. Each requires only a 5/16" drill bit.

Key Features & Benefits

- ▶ Strongest of all plastic toggle anchors—reinforces the wall or ceiling & leads the load away from the hole
- ▶ Vibration & shock proof—won't damage walls or ceiling
- ▶ Can use a screw gun—anti-rotation fins prevent spinning
- ▶ Accepts greatest range of screw sizes in each anchor
- ▶ All install in only a small 5/16" hole
- ▶ Pre-install without the screw
- ▶ Key-activated positive locking system
- ▶ Screw can be removed and reinserted in same anchor without loss of holding power
- ▶ Corrosion-proof when used with stainless steel screws
- ▶ Nonmagnetic, nonconductive
- ▶ Specially-designed heads for each application are engineered for ease of use and maximum performance.

For Use In:

- | | |
|----------------|----------------------|
| ▶ Gypsum Board | ▶ Plaster |
| ▶ Drywall | ▶ Accoustic Ceilings |
| ▶ Plasterboard | ▶ Tile over drywall |

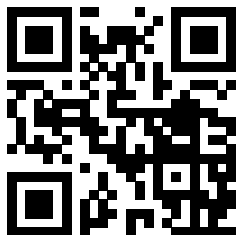

Scan for hollow material installation video

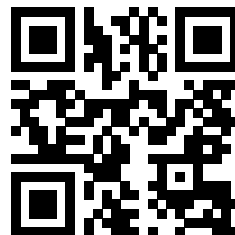

Scan for solid material installation video

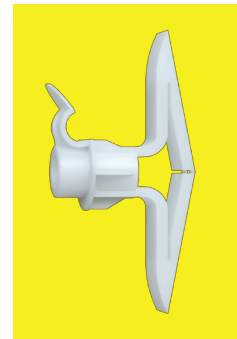

TOGGLER TH®
Picture Hook Anchors

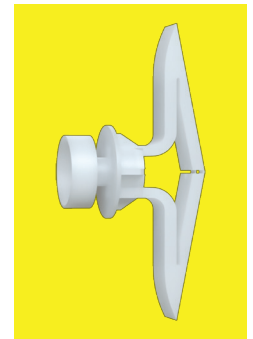

TOGGLER TBS1™
Shelving Anchors

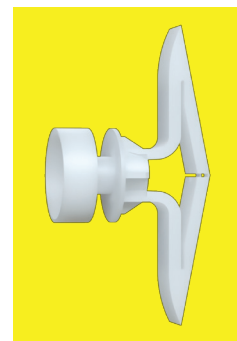

TBS2™
Pegboard Anchors

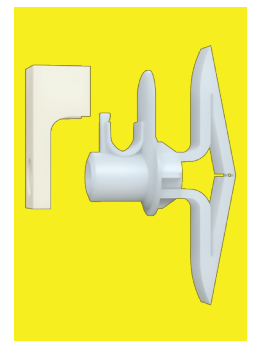

TBW™
Wire Shelf Anchors



Specifications, Listings and Approvals

Materials:

Specially formulated grade of non-corrodible polypropylene

Recommended Screw Size:

TH: #6 - #14 x 1-1/2"
TBS1: #7 X 1-3/4" flat head
TBS2: #8 X 1-3/4"
TBW: #8 X 1-3/4"

Grip Range: 3/8"-1/2"

Drill Bit Diameter: 5/16"

Note: In very hard materials, like ceramic tile, use 3/8" drill bit.

Fed Specs:

Type IV anchor in Federal Specification FF-B-588D (superseded)

TOGGLER TH® Picture Hook Anchors

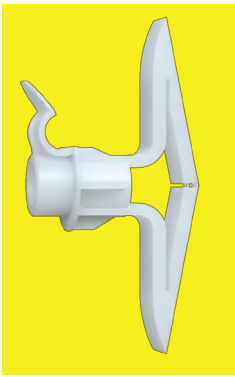

TOGGLER TH®
Picture Hook Anchors

Built-in hook for hanging paintings, prints, mirrors, and anything framed. Use also for telephone cable, household electrical wire, and TV/audio cable. The convenient plastic lip guides the wire into place, assuring easy, safe installation.

The TH® hook anchor, when used with a screw in hollow walls, holds 3x more than old-fashioned nail-in metal picture hooks. The weight of the picture rests on the screw, close to the wall, preventing pull-out. Corrosion-proof for hanging fixtures in humid areas, when used with a stainless steel or brass screw. Works in hollow, thick, and solid walls.

Installation Information

Instructions

1. Drill a 5/16" diameter hole—minimum hole depth in solid walls 1-1/4". Fold hook anchor, insert in hole, and tap flush with wall.
2. Insert red key to pop hook anchor open behind wall (except in thick or solid walls). **DO NOT HAMMER KEY.** Remove key.
- 3a. Insert screw and tighten until flush with hook anchor—then stop. Use screw enclosed in bag or any sheet metal screw from #6 through #14 with a minimum length of 1-1/2".
- 3b. The hook anchor also wedges securely in thick and solid walls. **Do NOT** use key.

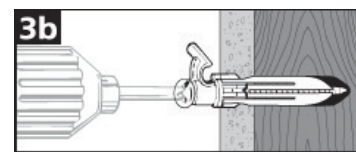
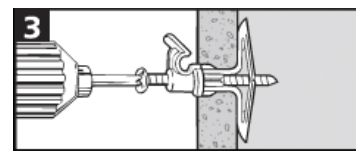
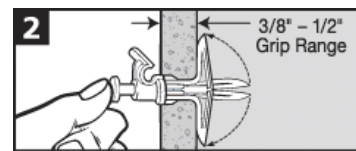
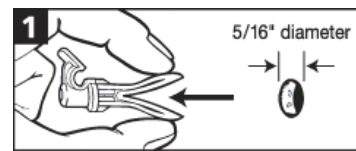

Installation Data

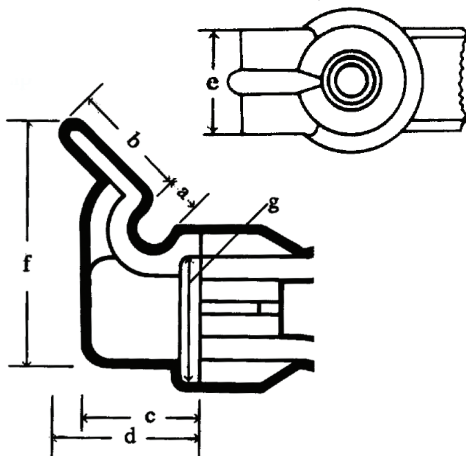

Minimum wall grip range: 3/8" - 1/2"

Minimum screw length: 1-1/2"

Screw type: #6 - #14 sheet metal

Minimum solid wall hole depth: 1-1/4"

- a: 0.15" hook diameter (flexibility of plastic permits insertion of object of greater diameter)
- b: 0.36" long guiding lip
- c: 0.34" off wall
- d: 0.44" including lip
- e: 0.31" hook width
- f: 0.77" total height including lip
- g: 0.46" flange diameter

TBS1 Shelving Anchors

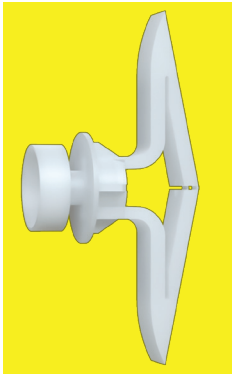

TBS1
Shelving Anchors

The built-in spacer is made to fit flush with shelving standards (C-channel) to ensure accurate alignment and to prevent the anchor from being jacked out of the wall during installation.

May be also used as a stand-off for installing equipment on warm or wet walls, or when ventilation is needed behind the installed object.

Installation Information

Instructions

1. Position standard on wall and hang it loosely by a nail from the top screw hole. (Gravity will hold standard straight.) Mark the remaining screw hole locations. Remove nail and standard.

Drill a 5/16" diameter hole at each mark—minimum hole depth in solid walls 1-1/4". Fold anchor, insert in hole, and tap flush with wall.

2. Insert black key to pop anchor open behind wall (except in thick or solid walls). **DO NOT HAMMER KEY.** Remove key.
3. Place standard over anchors. Insert screws and tighten until flush with standard—then stop. Use enclosed screws or any #7 x 1-3/4" flat head screw.

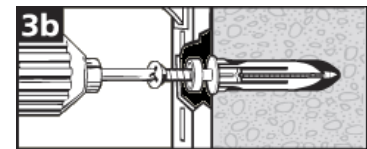
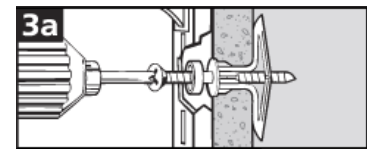
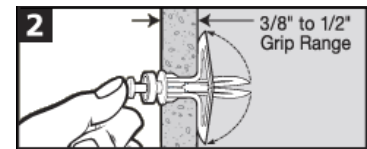
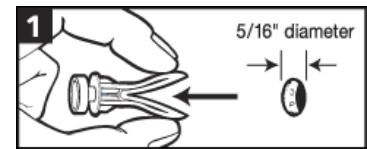

Installation Data

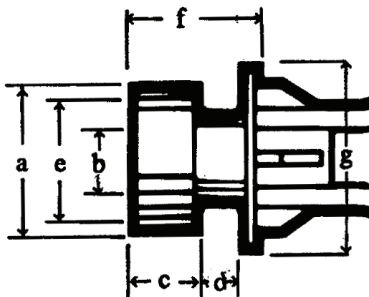

Minimum wall grip range: 3/8" - 1/2"

Minimum screw length: 1-3/4"

Screw type: #7 x 1-3/4" flat head (standard shelving bracket screw)

Minimum solid wall hole depth: 1-1/4"

- a: 0.46" standoff diameter
- b: 0.27" standoff base diameter
- c: 0.16" standoff height
- d: 0.14" standoff base height
- e: 0.34" standoff inner diameter
- f: 0.34" total standoff height
- g: 0.56" flange diameter

TBS2 Pegboard Anchors

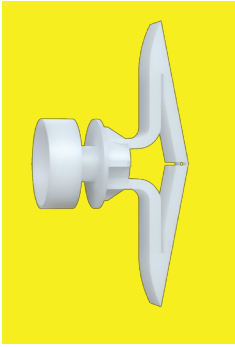

TBS2
Pegboard Anchors

Built-in spacers hold the pegboard the proper distance from the wall to allow peg hooks to work. The anchors eliminate furring strips, letting you configure the peg hooks in any arrangement you choose, quickly and easily, without losing the use of entire lines of peg holes.

May be also used as a stand-off for installing equipment on warm or wet walls, or when ventilation is needed behind the installed object.

Installation Information

Instructions

1. Position pegboard on wall and hold it in place with nails in corner peg holes. Mark every 24th hole across and down the pegboard for anchor locations. (Space anchors closer for extra support.) Remove pegboard and nails.

Drill a 5/16" diameter hole at each mark—minimum hole depth in solid walls 1-1/4". Fold anchor, insert in hole, and tap flush with wall.

2. Insert black key to pop anchor open behind wall (except in thick or solid walls). **DO NOT HAMMER KEY.** Remove key.
3. Place pegboard over anchors. Insert screws and tighten flush with pegboard—then stop. Use enclosed screws or any #8 x 1-3/4" pan head screw with a washer or a screw with a head larger than the peghole.

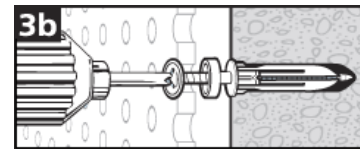
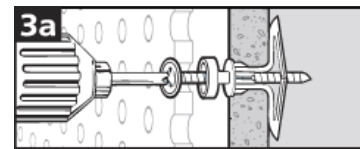
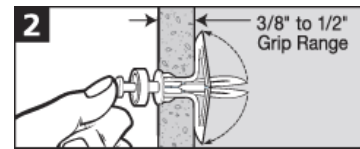
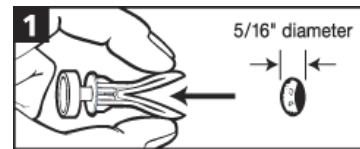

Installation Data

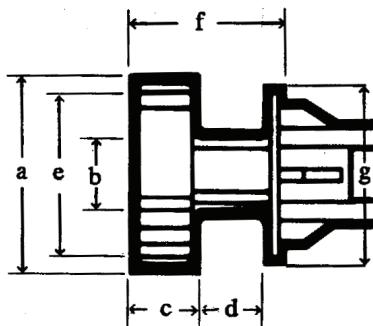

Minimum wall grip range: 3/8" - 1/2"

Minimum screw length: 1-3/4"

Screw type: #7 x 1-3/4" flat head (standard shelving bracket screw)

Minimum solid wall hole depth: 1-1/4"

- a: 0.46" standoff diameter
- b: 0.27" standoff base diameter
- c: 0.16" standoff height
- d: 0.14" standoff base height
- e: 0.34" standoff inner diameter
- f: 0.34" total standoff height
- g: 0.56" flange diameter

TBW Wire Shelf Anchors

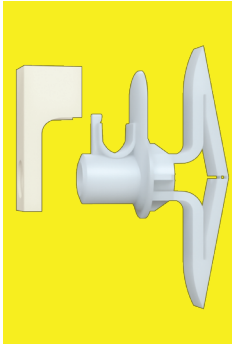

TBW
Wire Shelf Anchors

Designed specifically for wire shelving systems, each anchor is equipped with a retainer clip that locks the shelving in place. The shelf will not tip—even when the weight is distributed unevenly or near the edge. Ideal for use with systems like ClosetMaid® or SCHULTE®. Perfect for closet systems, kitchen shelves, and garage or workshop shelves. Use TOGGLER hollow-wall anchors for installing shelf supports and end brackets.

ClosetMaid is a registered trademark of Emerson Electric Co. SCHULTE is a registered trademark of SCHULTE Corporation.

Installation Information

Instructions

1. Mark a horizontal level line the length of the shelf 5/8" below the desired shelf top height. Make a mark 2-1/2" in from each end and additional marks spaced equally in between. (See recommended minimum quantity below.)

Drill a 5/16" diameter hole at each mark—minimum hole depth in solid walls 1-1/4". Fold anchor, insert in hole, and tap flush with wall.

2. Insert black key to pop anchor open behind wall (except in thick or solid walls). **DO NOT HAMMER KEY.** Remove key.
3. Snap shelf onto anchors and let it hang down against wall. Place plastic retainer over anchor, insert screw and tighten flush with retainer—then stop. Use enclosed screws or any fully-threaded #8 x 1-3/4" pan head screw.

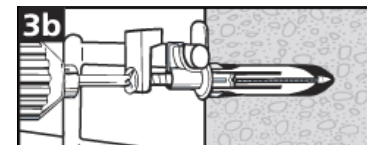
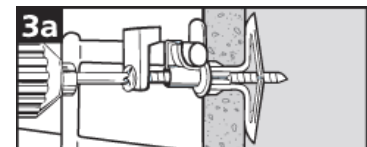
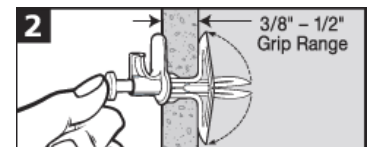
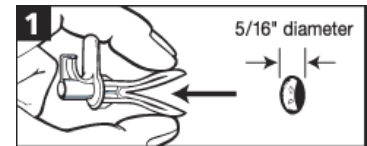

Minimum quantity TBW anchors for following shelf lengths: 24" (3), 36" & corner shelf (4), 48" (5), 60" (6), 72" (7).

Follow shelf manufacturer's instructions for installing shelf supports and end brackets, using TOGGLER BRAND TB® or TC® plastic toggle anchors.

Installation Data

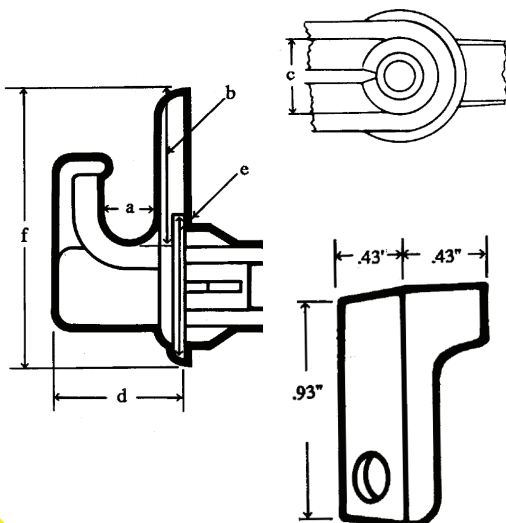

Minimum wall grip range: 3/8" - 1/2"

Minimum screw length: 1-3/4"

Screw type: #8 x 1-3/4"

Minimum solid wall hole depth: 1-1/4"

- a: 0.30" hook diameter; (flexibility of plastic permits insertion of object of greater diameter)
- b: 0.65" rear wall bumper height
- c: 0.32" hook width
- d: 0.52" standoff distance
- e: 0.55" flange diameter
- f: 1.06" total hook height

Order Information

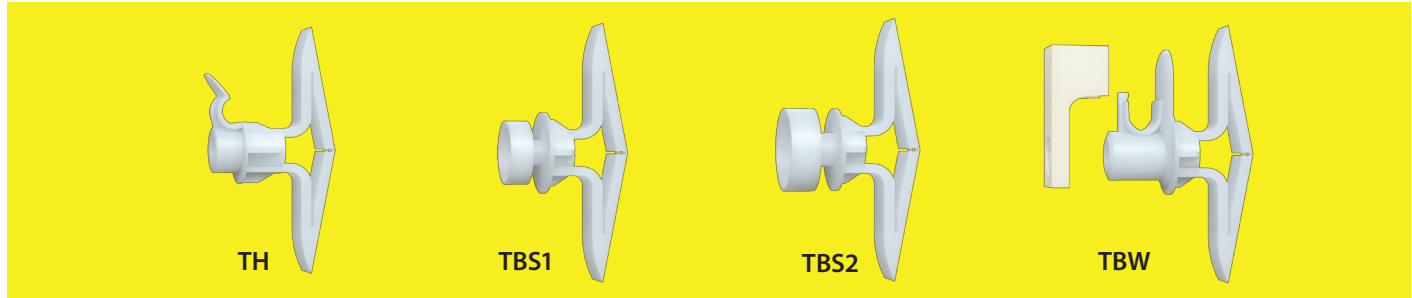

TOGGLER® Specialty Anchors

Catalog Number	Style	Drill Bit Size (in.)*	Screw Size Range	Grip Range (in.)	Included Screw Size**	Box / Bag (pcs.)	Master Carton (pcs.)
11012	TH	5/16	#6 - #14	3/8 - 1/2	no screws	100	1000
50225	TH	5/16	#6 - #14	3/8 - 1/2	#8 x 1-1/2	5	50
11023	TBS1	5/16	#6 - #14	3/8 - 1/2	no screws	50	500
11022	TBS2	5/16	#6 - #14	3/8 - 1/2	no screws	50	500
50200	TBS2	5/16	#6 - #14	3/8 - 1/2	#8 x 1-3/4	9	90
11024	TBW	5/16	#6 - #14	3/8 - 1/2	no screws	50	500

* In very hard materials, like ceramic tile, drill a 3/8" hole.

**SMS: Sheet Metal Screw

All Styles of Plastic Toggle Specialty Anchors Available in Bulk.

For more information, please contact:



Divisions of Mechanical Plastics Corp.

110 Richards Avenue • Norwalk, CT 06854

Phone: 203-857-2200

Fax: 203-857-2201 • E-mail: sales@wej-it.com

www.toggler.com • www.wej-it.com

TOGGLER® typeface, Wej-It®, High-Performance Anchors®, TH®, TBW™, TBS1™, TBS2™ are worldwide trademarks of Mechanical Plastics Corp.

©2015, 2021 Mechanical Plastics Corp. REV. 3/24